

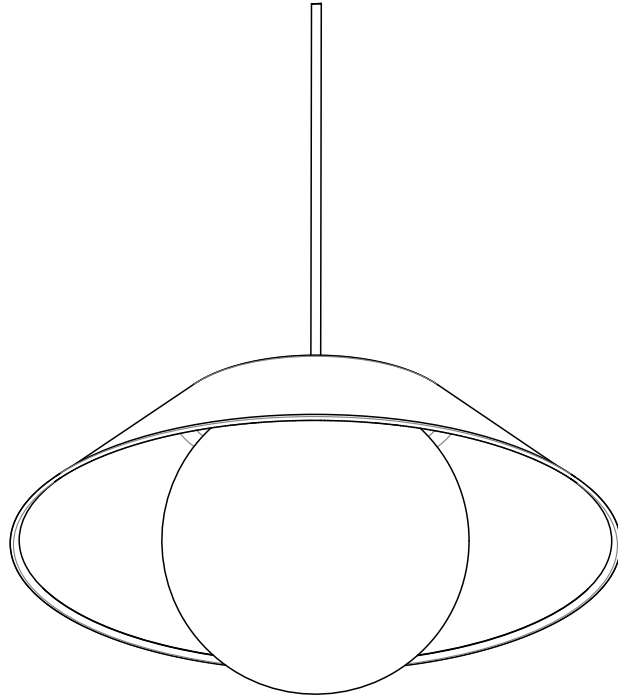

Akoya

12435 rB

AC Input



CAUTION:

Before starting, turn off power at main circuit panel.

ADVERTENCIA:

Antes de comenzar la instalación, apague la corriente en el tablero principal.

ATTENTION:

Coupez l'alimentation avant de proceder à l'installation.



Calling for backup? Scan above to contact our team.

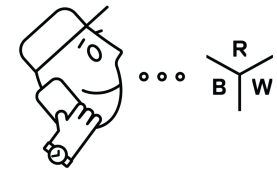

www.RBW.com

+1 212 388 0399

support@RBW.com

© RBW Studio LLC, 2013, 2020

* If M22 See Install Steps on Pages 3-4

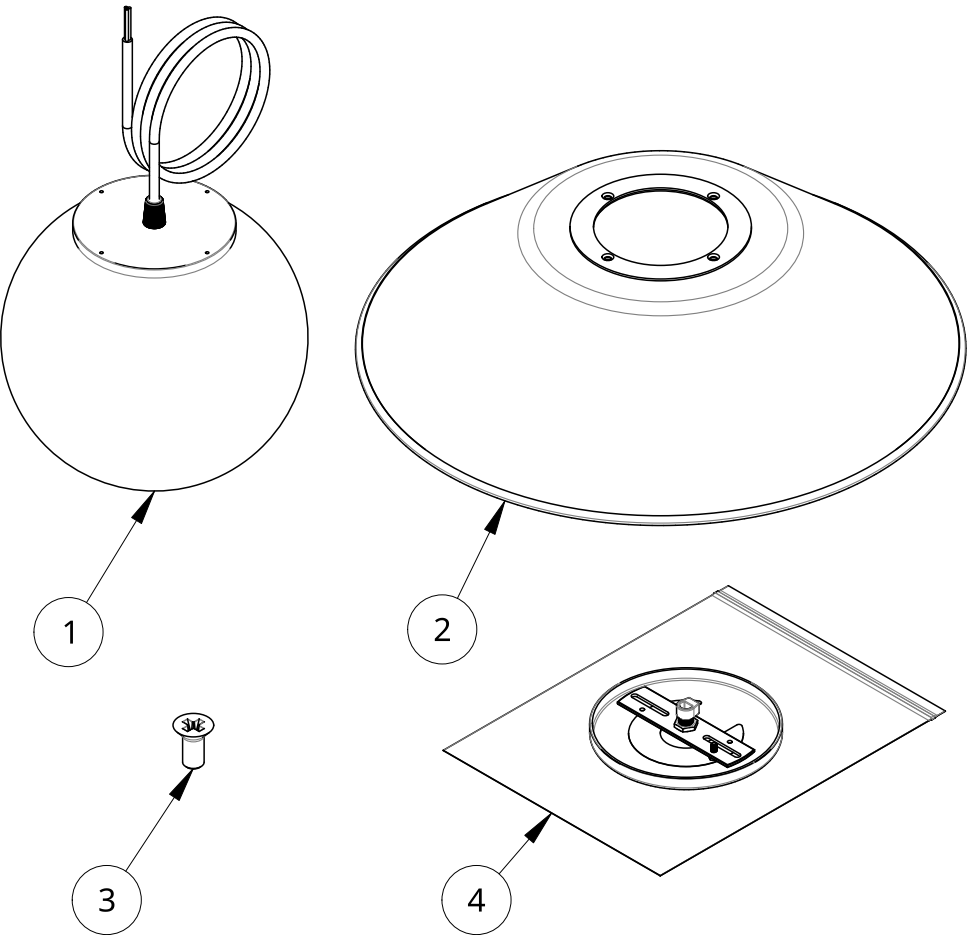

Item	Qty	Part number	Description
1	1	14936-27	Assembly: Akoya 8in. 2700K. 82in White Cord.
2	1	12242-PC20	Akoya Shade. M14. Matte White.
3	4	90273A106	Flat countersunk head (82) machine screw #4-40 x 0.25 Stainless Steel
4	1	15033	Package: Flat Round Cord Suspension. UL 1598. White

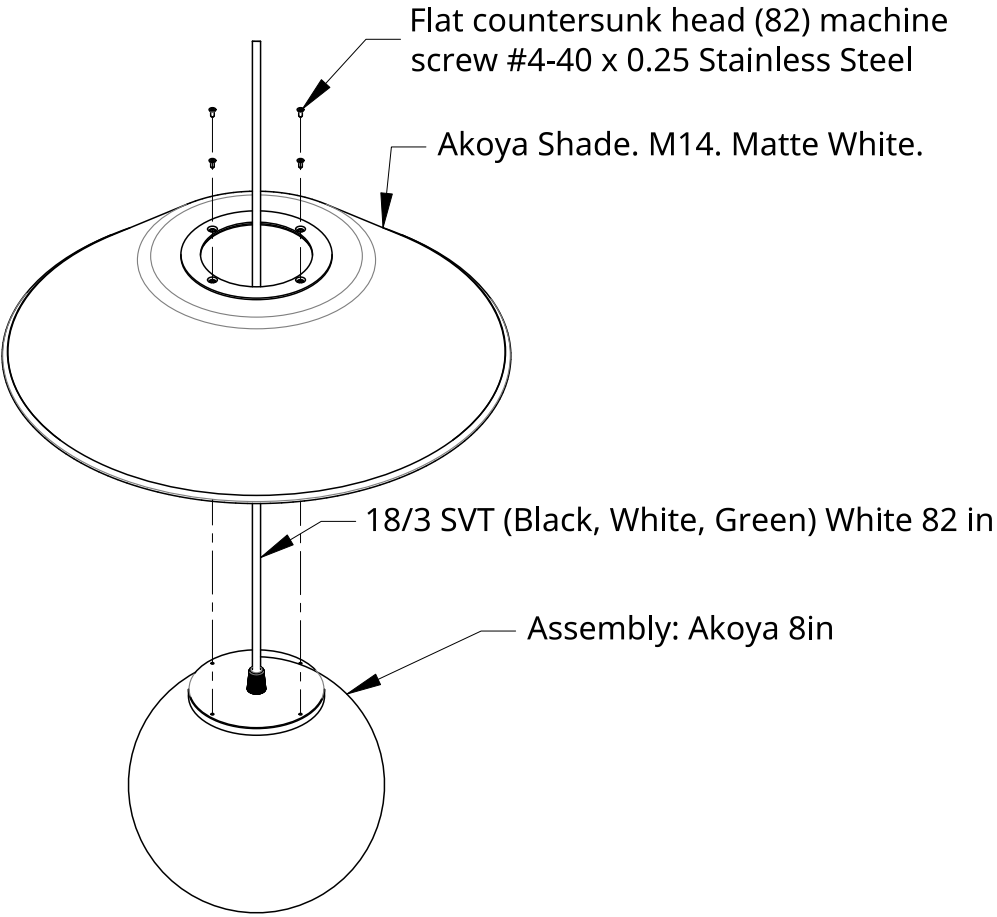

Installation - Shade

1. Pass SVT Power Cord through center hole of Akoya Shade.
2. Secure Akoya Shade to Akoya Assembly using #4-40 Screws.

See Canopy Install Instructions 15675 for information on ceiling canopy installation.

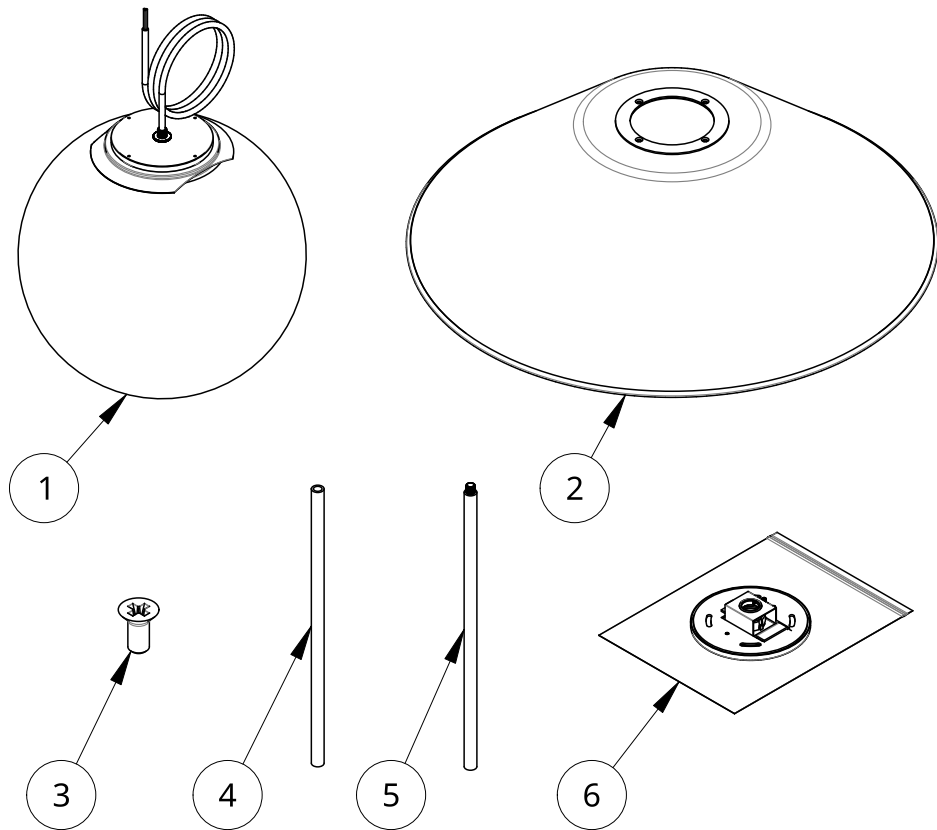

Item	Qty	Part number	Description
1	1	15571-27	Assembly: Akoya 12in. 2700K. 82in White Cord.
2	1	12243-PC20	Akoya Shade. M22. Matte White.
3	4	90273A106	Flat countersunk head (82) machine screw #4-40 x 0.25 Stainless Steel
4	1	11085-PC20	Pendant Stem 14". White
5	1	10311-PC20	14" Stem Assembly w 1/8 IPS Nipple. White
6	1	12540-PC20	Package: Flat Round ADJ Canopy Kit. UL 2108. Matte White

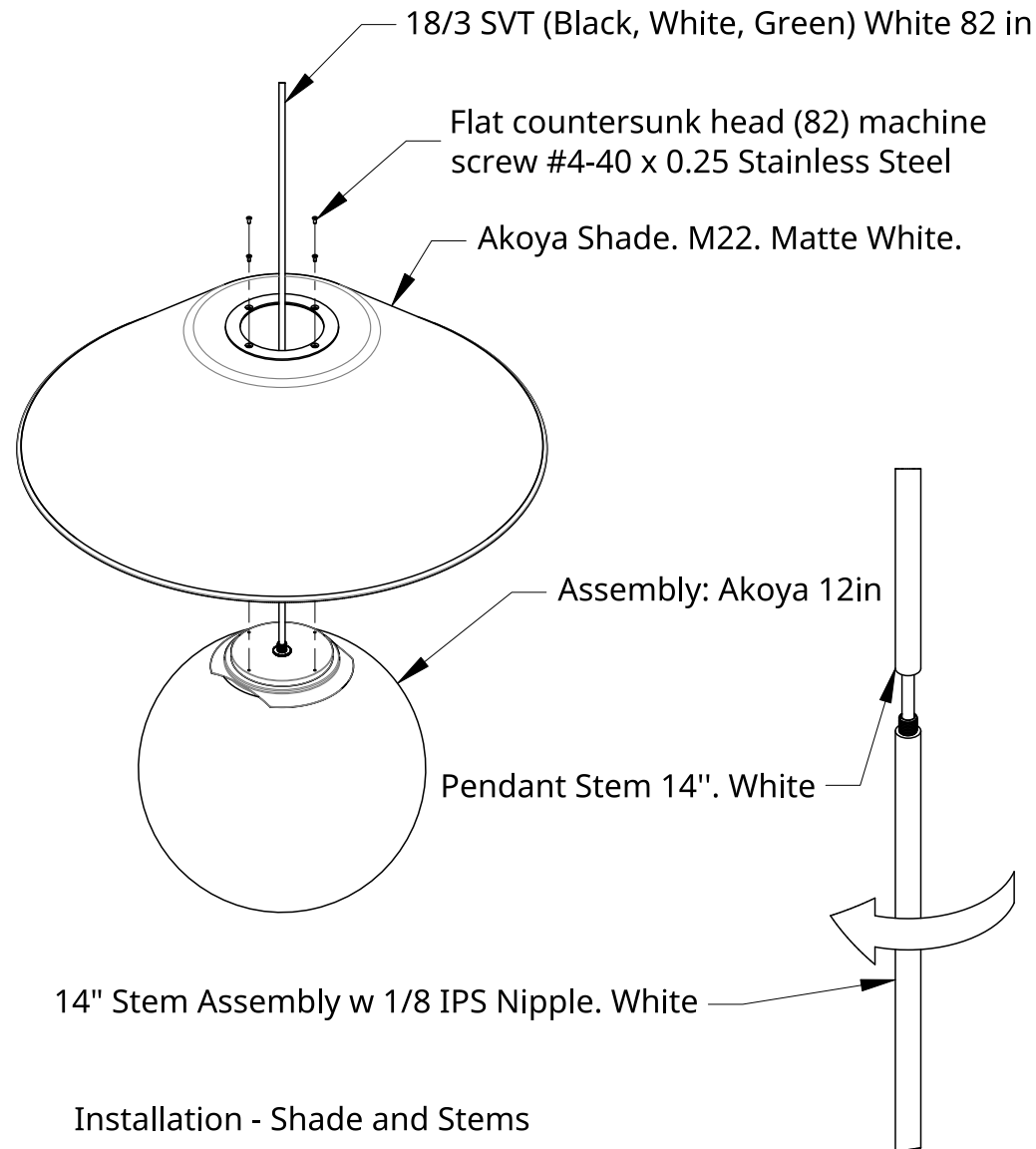

Installation - Shade and Stems

1. Pass SVT Power Cord through center of Akoya Shade
2. Secure Akoya Shade to Akoya Assembly using #4-40 Screws.
3. Pass SVT Power Cord through Stem Assembly w/ 1/8 IPS Nipple and Pendant Stem.
4. Thread Pendant Stem onto 1/8 IPS Nipple of Stem Assembly.

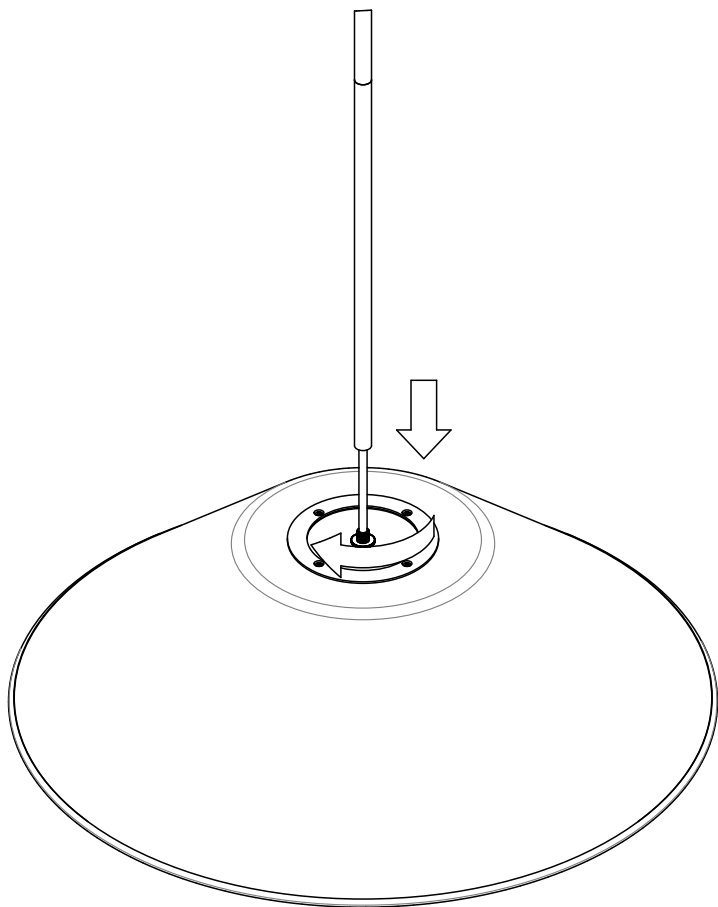

Installation - Stems

5. Lower Stems onto Akoya Assembly and fasten to 1/8 IPS Nipple.
6. Congratulations! End of guide.

See Canopy Install Instructions 13073 for information on ceiling canopy installation.